

POTTORFF®

Superior Water-Penetration Performance Model EDD-637 Dual-Drainable Louver

Introducing our best-in-class
6" EDD-637 dual-drainable
blade louver.

Pottorff's EDD-637 features
57% free area and a beginning
point of water penetration of
1,113 fpm with pressure loss
of only 0.15 in. wg. for greater
fan efficiency.

The EDD-637 is AMCA Certified
and is designed to prevent water
penetration in non-wind-driven
rain applications by collecting
water in frame and dual blade
gutters and channeling it directly
into two independent downspouts
and away from airflow paths.



Pottorff certifies that Model EDD-637 is licensed to bear the AMCA Seal. The ratings shown are based on tests and procedures performed in accordance with AMCA 511 and comply with the requirements of the AMCA Certified Ratings Program. The AMCA Seal applies to air performance and water penetration only. Test size 48" x 48", 15 minute test duration (for water penetration), EDD-637 July, 2012.



POTTORFF®

Visit www.pottorff.com for more information about this model.

Application

The EDD-637 dual-drainable blade louver is designed to prevent water penetration in non-wind-driven rain applications by collecting water in frame and blade gutters and channeling it into downspouts and away from airflow paths. The EDD-637 is available in a wide array of anodized and painted finishes including custom color matching.

Ratings

Free Area: [48" x 48" (1222 x 1222) unit]: 9.2ft² (0.85 m²) 57.5%

Performance @ Beginning Point of Water Penetration

Free Area Velocity: 1,113 fpm (5.65 m/s) **Air Volume Delivered:** 10,242 cfm (4.83 m³/s)

Pressure Loss: 0.15 in.wg. (37 Pa)

Velocity @ 0.15 in.wg. Pressure Loss: 1106 fpm (5.62 m/s) **Design Load:** 25 psf

Standard Construction

Material: Mill finish 6063-T5 extruded aluminum.

Frame: 6" deep x 0.081" thick (152 x 2) channel.

Blades: 37¹/₂" x 0.081" (2) thick dual-drainable style.

Screen: 1/2" x 0.063" (12.7 x 1.6) expanded and flattened aluminum.

Mullion: Visible.

Minimum Size: 4.5" x 8" (114 x 203)

Maximum Size: Single section: 60" x 120" (1524 x 3048)
120" x 60" (3048 x 1524)
Multiple section: Unlimited

Options

- Factory finish:
 - High Performance Fluoropolymer - 100% resin Newlar®/70% resin Kynar®
 - Baked Enamel
 - Clear or Color Anodized, Class 1
 - Prime Coat
- Hidden vertical mullion for continuous blade appearance.
- 1" x 3/4" (25 x 19) glazing frame.
- 1 1/2" (38) flange frame.
- Welded construction.
- Alternate bird or insect screens.
- Insulated or non-insulated blank-off panels.
- Filter racks.
- Hinged frame.
- Head and/or sill flashing.

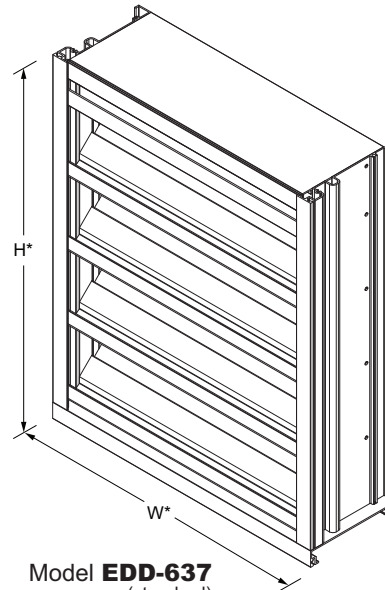

Model EDD-637
(standard)
*Louver dimensions furnished approximately 1/2" (13) undersize.

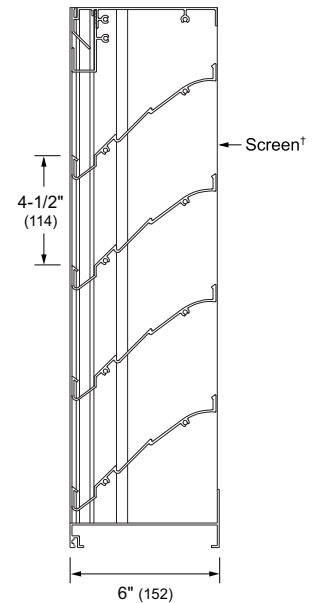

Vertical Section
†Screen adds approximately 3/16" (5) to louver depth.

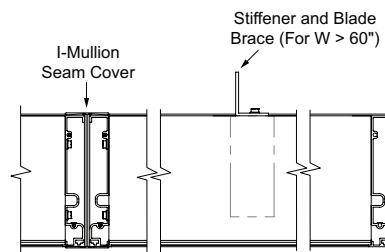

Visible Vertical Mullion
(standard)

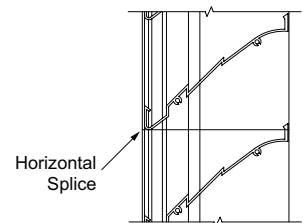

Horizontal Mullion
(standard)

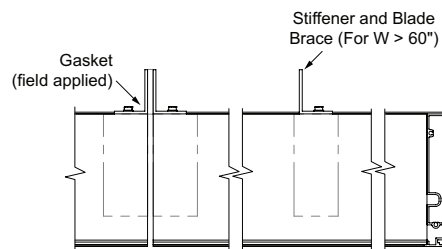

Hidden Vertical Mullion
(optional)

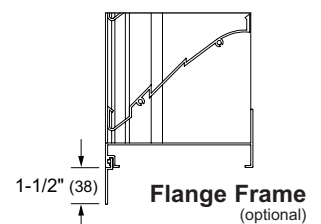

Flange Frame
(optional)



Certified Ratings:

Pottorff certifies that the model EDD-637 shown herein is licensed to bear the AMCA seal. The ratings shown are based on test and procedures performed in accordance with AMCA Publication 511 and comply with the requirements of the AMCA Certified Ratings Program. The AMCA Certified Ratings seal applies to air performance and water penetration ratings.