

8 7 6 5 4 3 2 1

INSTALLATION LIFTING POINT

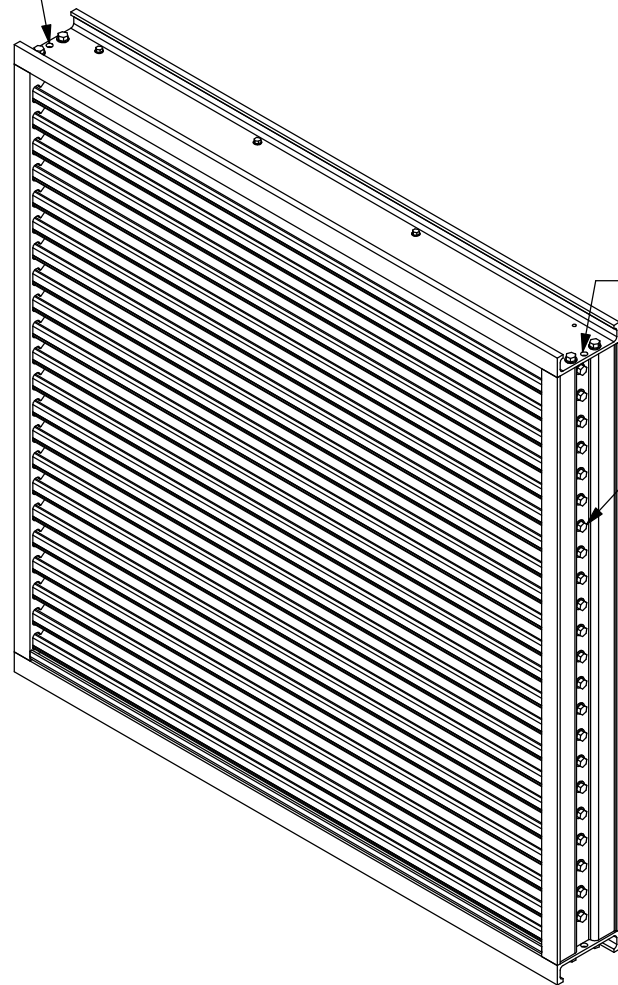

INSTALLATION LIFTING POINT

3/8-16 x 1 1/2" SELF-TAPPING SCREWS

5" X 2 1/2" X 3/16" CHEVRON BLADES

EXTRUDED NON-FLANGED FRAME

GRILLE WIDTH MEASURED OUTSIDE JAMBS (TYPICAL REGARDLESS OF CONFIGURATION)

GRILLE HEIGHT MEASURED OUTSIDE TOP/BOTTOM (TYPICAL REGARDLESS OF CONFIGURATION)

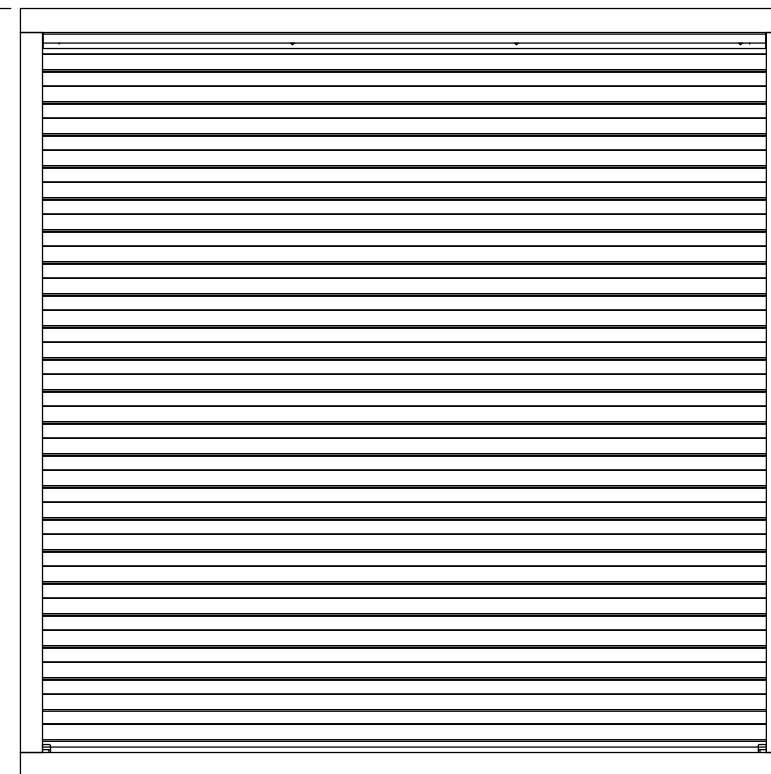

NON-FLANGED EXTERIOR VIEW

GRILLE IS SIZED 1/2" UNDER NOMINAL SIZE

NOTES:

1. THIS DRAWING INCLUDES INSTALLATION DETAILS TO ATTAIN A 300-PSF DESIGN PRESSURE ACROSS ALL SIZES AND IMPACT RESISTANCE PER FEMA 361/320 AND ICC 500.
2. GRILLE TESTED FOR LARGE MISSILE IMPACT TEST WITH 15 LB 2 X 4 AND 100 MPH VELOCITY.
3. IT IS ASSUMED THAT THE GRILLE SYSTEMS DO NOT SUPPORT ANY LOADS TRANSFERRED FROM THE BUILDING CONDITION.
4. IT IS ASSUMED THAT THE BUILDING CONDITIONS ARE ADEQUATELY DESIGNED TO SUPPORT LOADS IMPARTED BY THE GRILLE.
5. GRILLE DOES NOT PREVENT MOISTURE INGRESS. CRITICAL EQUIPMENT SHOULD BE PROTECTED.
6. ALL HARDWARE SHOWN IS SUPPLIED BY POTTORFF UNLESS OTHERWISE SPECIFIED. HARDWARE IS SHIPPED LOOSE, MILL FINISH.
7. SEPARATION OF DISSIMILAR METALS / ALUM. TO STEEL SHOULD BE TAKEN INTO CONSIDERATION, AND IS BY OTHERS UNLESS SPECIFIED OTHERWISE.
8. ALL BACKER ROD, SEALANT/CAULKING IS SUPPLIED BY OTHERS.
9. ALL HOLES, HARDWARE, ANCHORS, AND/OR SHIMS REQUIRED TO INSTALL UNITS TO BUILDING, STRUCTURE, OR EXISTING CONDITION BY OTHERS. HOLES AND HARDWARE, WHERE SHOWN, ARE MINIMUM SIZES, QUANTITIES, AND/OR SPACING RECOMMENDED BY POTTORFF. THE E.O.R. HAS FINAL RESPONSIBILITY FOR SIZE AND QUANTITY OF ANCHORS.
10. APPROXIMATE WEIGHT FOR GRILLE IS 15 LBS/SQ-FT.

UNLESS OTHERWISE SPECIFIED DIMENSION ARE IN INCHES

TOLERANCE UNLESS NOTED:
 X.X ±0.060
 X.XX ±0.030
 X.XXX ±0.010
 ANGLE ±1°
 FRACTION ±1/16

MAX HOLE BREAKOUT:
 15% OF MATERIAL THICKNESS

5101 Blue Mound Road
 Fort Worth, Texas 76106
 Phone: 817-509-2300
 Fax: 817-831-3110

THIRD ANGLE PROJECTION

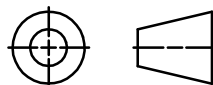

POTTORFF®

THIS DRAWING AND THE DESIGN REPRESENTED ARE THE CONFIDENTIAL AND PROPRIETARY PROPERTY OF PCI INDUSTRIES AND MAY NOT BE DISCLOSED, LOANED, COPIED, OR USED FOR ANY PURPOSE OTHER THAN DESIGN REVIEW AND APPROVAL WITHOUT THE EXPRESS WRITTEN CONSENT OF PCI INDUSTRIES.

DRAWING DESCR: COVER SHEET

PROJECT: XCD-545 FEMA 361/320 GRILLE ASSEMBLY & INSTALLATION DETAILS

LOCATION:

CUSTOMER:

PROJ. MGR.: DILLON AUSMUS

DRAWN BY: DJA

DATE: 5/19/2022

CHK'D BY: JMR

ORDER NUMBER

P.O. NUMBER

DRAWING NUMBER

SHEET: 1 of 9

SCALE: NONE

70219 C-1

REV.	DESCRIPTION	DATE	DRAWN BY
8			
7			
6			

8 7 6 5 4 3 2 1

SINGLE SECTION ASSEMBLIES

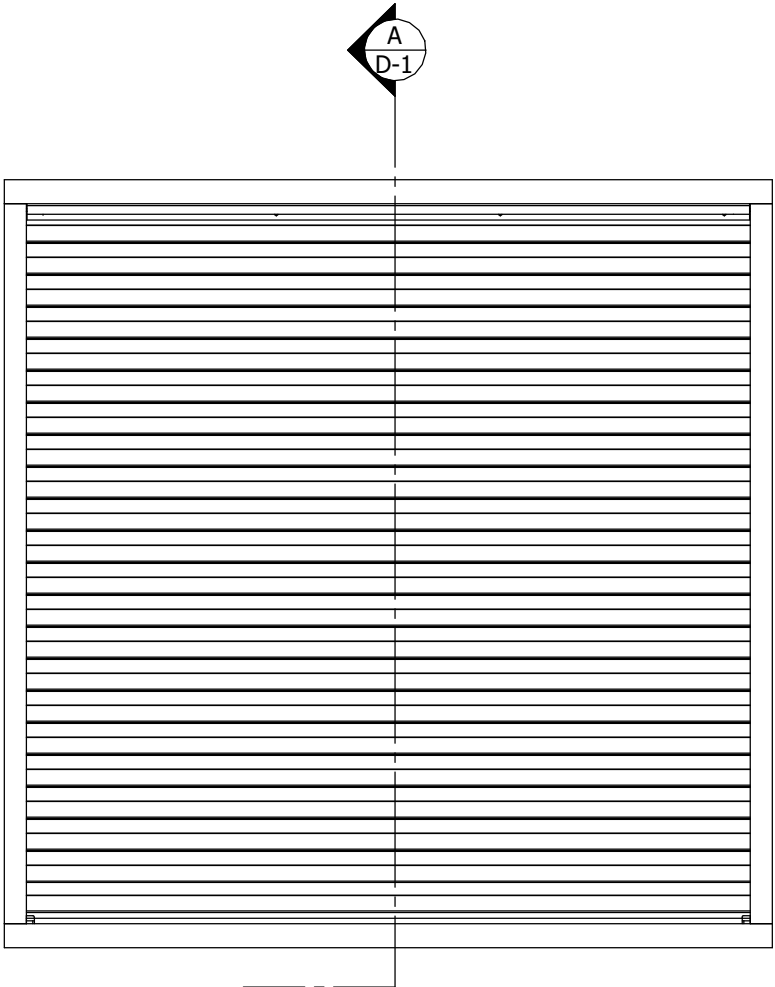

SINGLE SECTION ARRANGEMENT
NON-FLANGED
 INTERNAL MOUNT, EXTERIOR VIEW

UNLESS OTHERWISE SPECIFIED
 DIMENSION ARE IN INCHES

TOLERANCE UNLESS NOTED:
 X.X ±0.060
 X.XX ±0.030
 X.XXX ±0.010
 ANGLE ±1°
 FRACTION ±1/16

MAX HOLE BREAKOUT:
 15% OF MATERIAL THICKNESS

5101 Blue Mound Road
 Fort Worth, Texas 76106
 Phone: 817-509-2300
 Fax: 817-831-3110

THIRD ANGLE PROJECTION

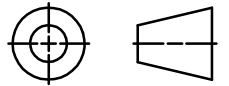

POTTORFF®

THIS DRAWING AND THE DESIGN REPRESENTED ARE
 THE CONFIDENTIAL AND PROPRIETARY PROPERTY OF
 PCI INDUSTRIES AND MAY NOT BE DISCLOSED, LOANED,
 COPIED, OR USED FOR ANY PURPOSE OTHER THAN DESIGN
 REVIEW AND APPROVAL WITHOUT THE EXPRESS WRITTEN
 CONSENT OF PCI INDUSTRIES.

DRAWING DESCR: ELEVATION VIEWS, SINGLE SECTION ASSEMBLIES				
PROJECT: XCD-545 FEMA 361/320 GRILLE ASSEMBLY & INSTALLATION DETAILS				
LOCATION:				
CUSTOMER:				
PROJ. MGR.: DILLON AUSMUS			DRAWN BY: DJA	
DATE: 5/19/2022	CHK'D BY: JMR	ORDER NUMBER	P.O. NUMBER	DRAWING NUMBER
SHEET: 2 of 9	SCALE: NONE			70219 E-1

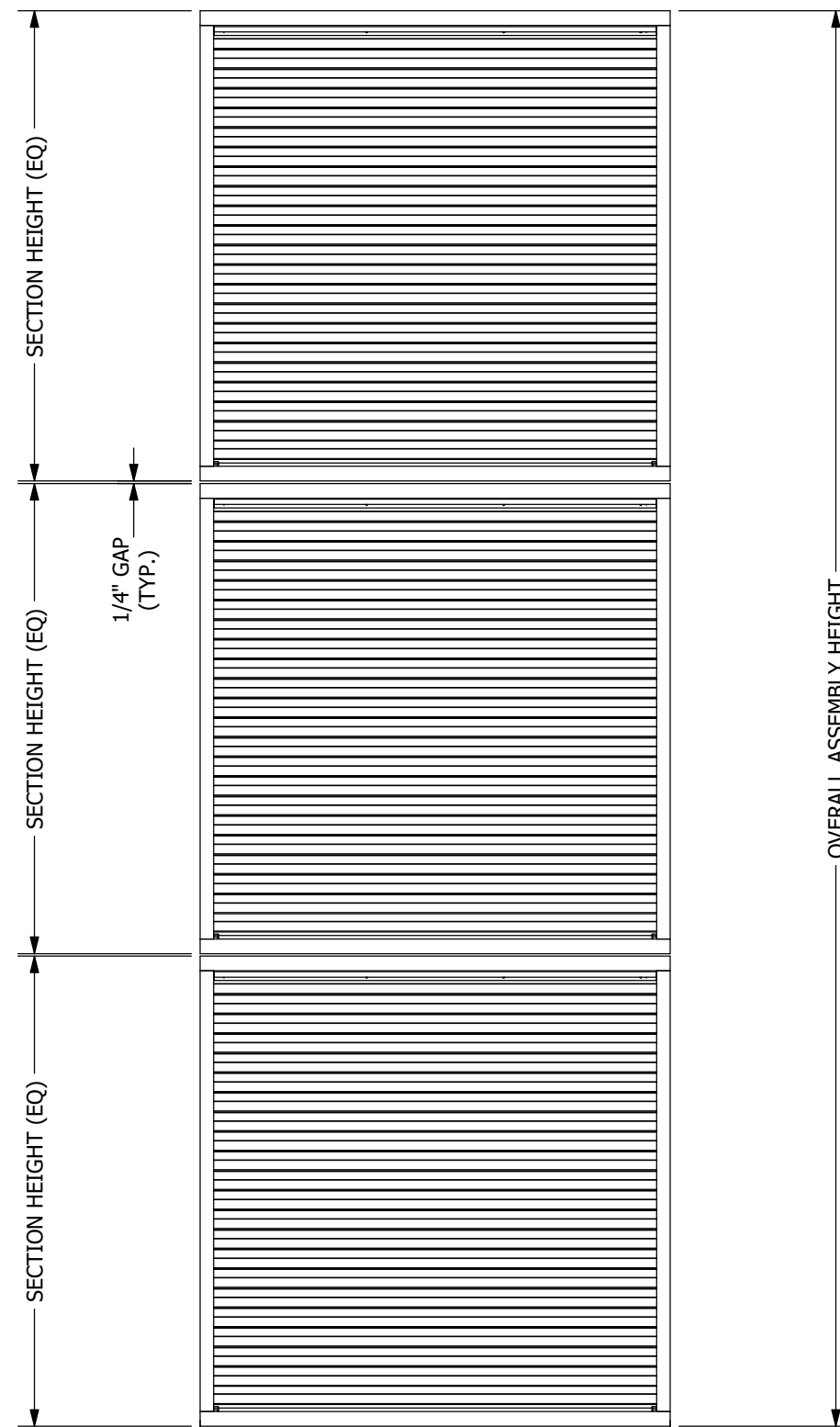

GRILLE WIDTH MEASURED OUTSIDE JAMBS

MULTI-SECTION HIGH (UNLIMITED) ARRANGEMENT
NON-FLANGED
 INTERNAL MOUNT, EXTERIOR VIEW

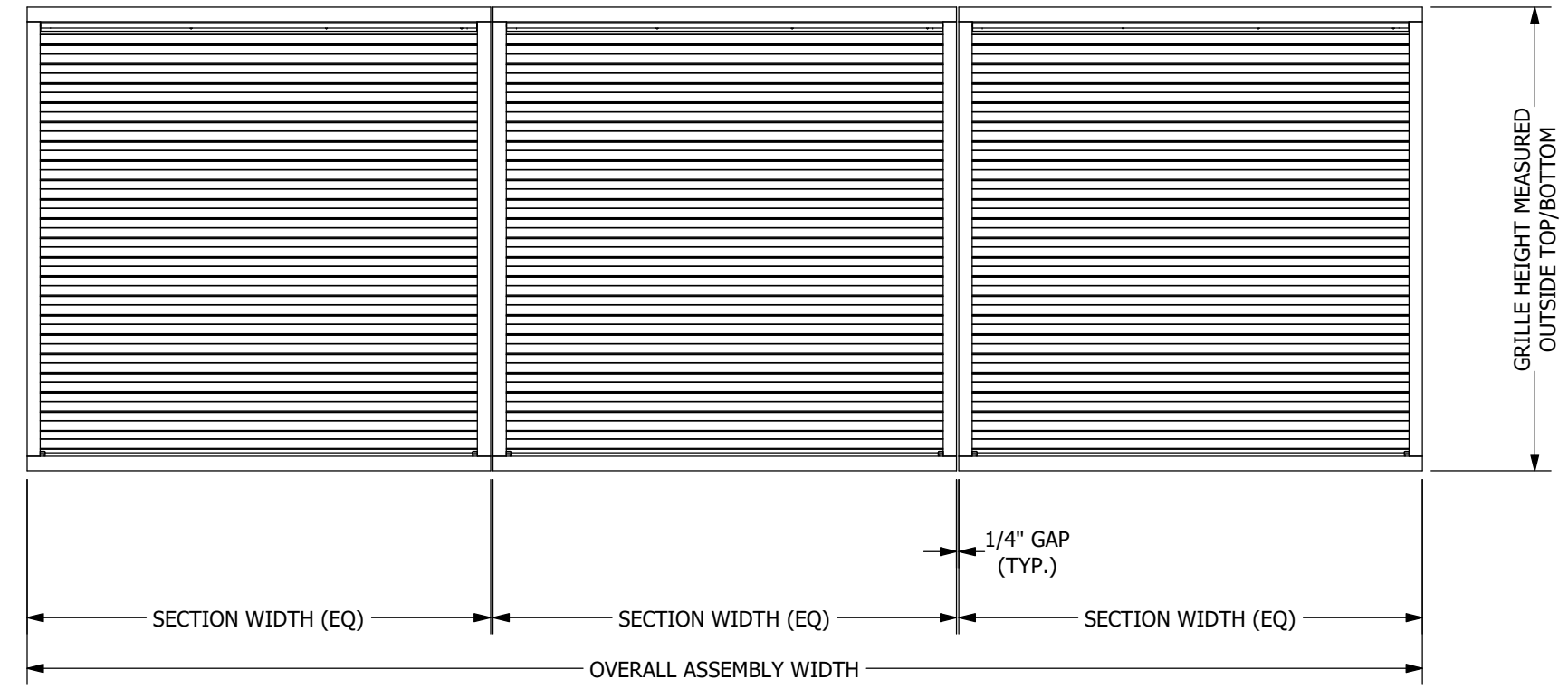

MULTI-SECTION WIDE (UNLIMITED) ARRANGEMENT
NON-FLANGED
 INTERNAL MOUNT, EXTERIOR VIEW

- NOTES:
 1. MULTI-SECTION CONFIGURATIONS ARE AVAILABLE ONLY IN MULTI-SECTION HIGH X SINGLE SECTION WIDE OR MULTI-SECTION WIDE X SINGLE SECTION HIGH. NO PROVISIONS HAVE BEEN MADE FOR MULTI-SECTION HIGH X MULTI-SECTION WIDE CONFIGURATIONS.

UNLESS OTHERWISE SPECIFIED
 DIMENSION ARE IN INCHES

TOLERANCE UNLESS NOTED:
 X.X ±0.060
 X.XX ±0.030
 X.XXX ±0.010
 ANGLE ±1°
 FRACTION ±1/16

MAX HOLE BREAKOUT:
 15% OF MATERIAL THICKNESS

5101 Blue Mound Road
 Fort Worth, Texas 76106
 Phone: 817-509-2300
 Fax: 817-831-3110

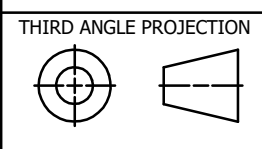

POTTORFF®

THIS DRAWING AND THE DESIGN REPRESENTED ARE THE CONFIDENTIAL AND PROPRIETARY PROPERTY OF PCI INDUSTRIES AND MAY NOT BE DISCLOSED, LOANED, COPIED, OR USED FOR ANY PURPOSE OTHER THAN DESIGN REVIEW AND APPROVAL WITHOUT THE EXPRESS WRITTEN CONSENT OF PCI INDUSTRIES.

DRAWING DESCR: ELEVATION VIEWS, MULTI-SECTION ASSEMBLIES				
PROJECT: XCD-545 FEMA 361/320 GRILLE ASSEMBLY & INSTALLATION DETAILS				
LOCATION:				
CUSTOMER:				
PROJ. MGR.: DILLON AUSMUS		DRAWN BY: DJA		
DATE: 5/19/2022	CHK'D BY: JMR	ORDER NUMBER	P.O. NUMBER	DRAWING NUMBER
SHEET: 3 of 9	SCALE: NONE			70219 E-2

SECTIONS & DETAILS

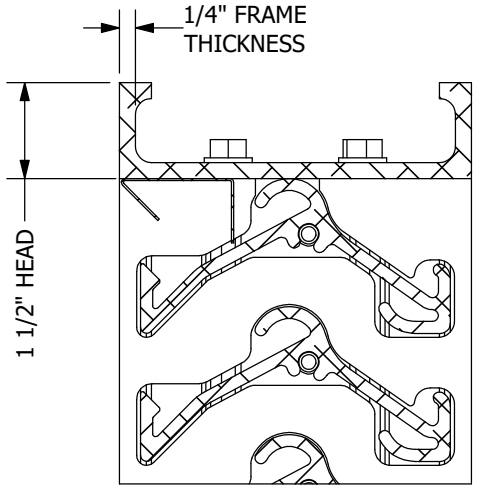
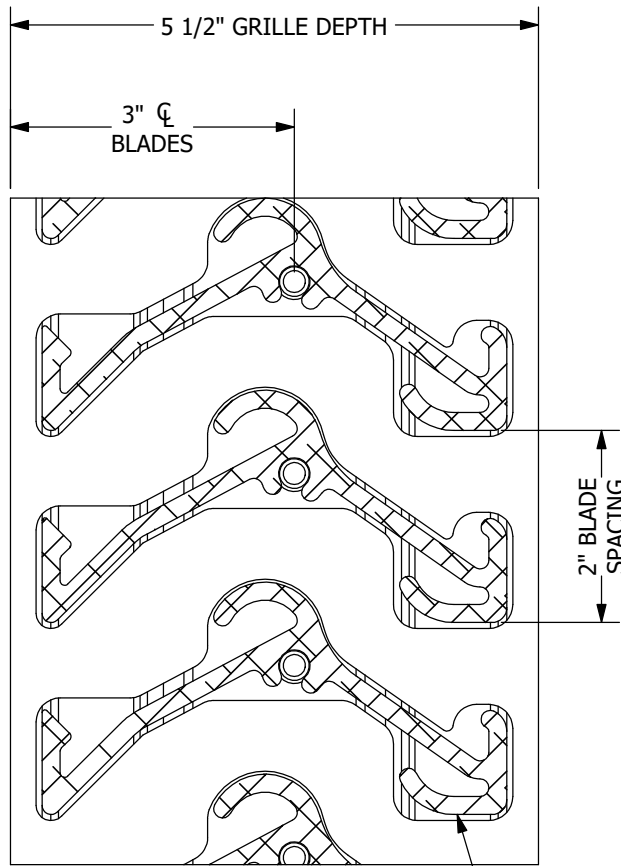
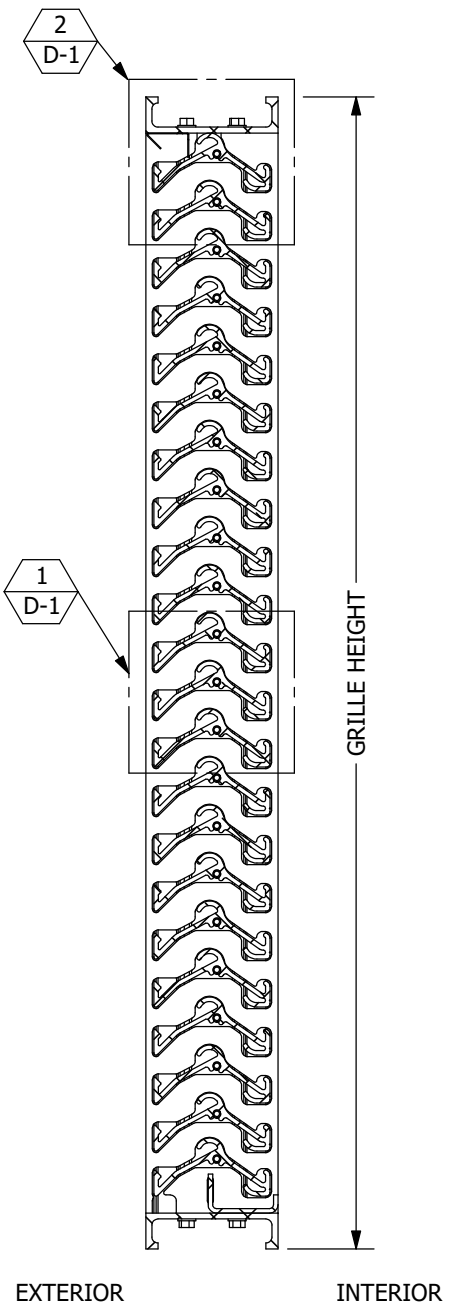

LOUVER **2** DETAIL
SCALE: 4"=1' D-1 D-1

5" X 2 1.2" X 3/16"
6061-T6 ALUMINUM
CHEVRON BLADES

UNLESS OTHERWISE SPECIFIED
DIMENSION ARE IN INCHES

TOLERANCE UNLESS NOTED:
X.X ±0.060
X.XX ±0.030
X.XXX ±0.010
ANGLE ±1°
FRACTION ±1/16

MAX HOLE BREAKOUT:
15% OF MATERIAL THICKNESS

5101 Blue Mound Road
Fort Worth, Texas 76106
Phone: 817-509-2300
Fax: 817-831-3110

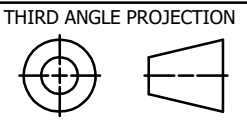

POTTORFF

THIS DRAWING AND THE DESIGN REPRESENTED ARE
THE CONFIDENTIAL AND PROPRIETARY PROPERTY OF
PCI INDUSTRIES AND MAY NOT BE DISCLOSED, LOANED,
COPIED, OR USED FOR ANY PURPOSE OTHER THAN DESIGN
REVIEW AND APPROVAL WITHOUT THE EXPRESS WRITTEN
CONSENT OF PCI INDUSTRIES.

DRAWING DESCR: SECTIONS & DETAILS				
PROJECT: XCD-545 FEMA 361/320 GRILLE ASSEMBLY & INSTALLATION DETAILS				
LOCATION:				
CUSTOMER:				
PROJ. MGR.: DILLON AUSMUS		DRAWN BY: DJA		
DATE: 5/19/2022	CHK'D BY: JMR	ORDER NUMBER	P.O. NUMBER	DRAWING NUMBER
SHEET: 4 of 9	SCALE: AS NOTED			70219 D-1

NON-FLANGED TOP/BOTTOM

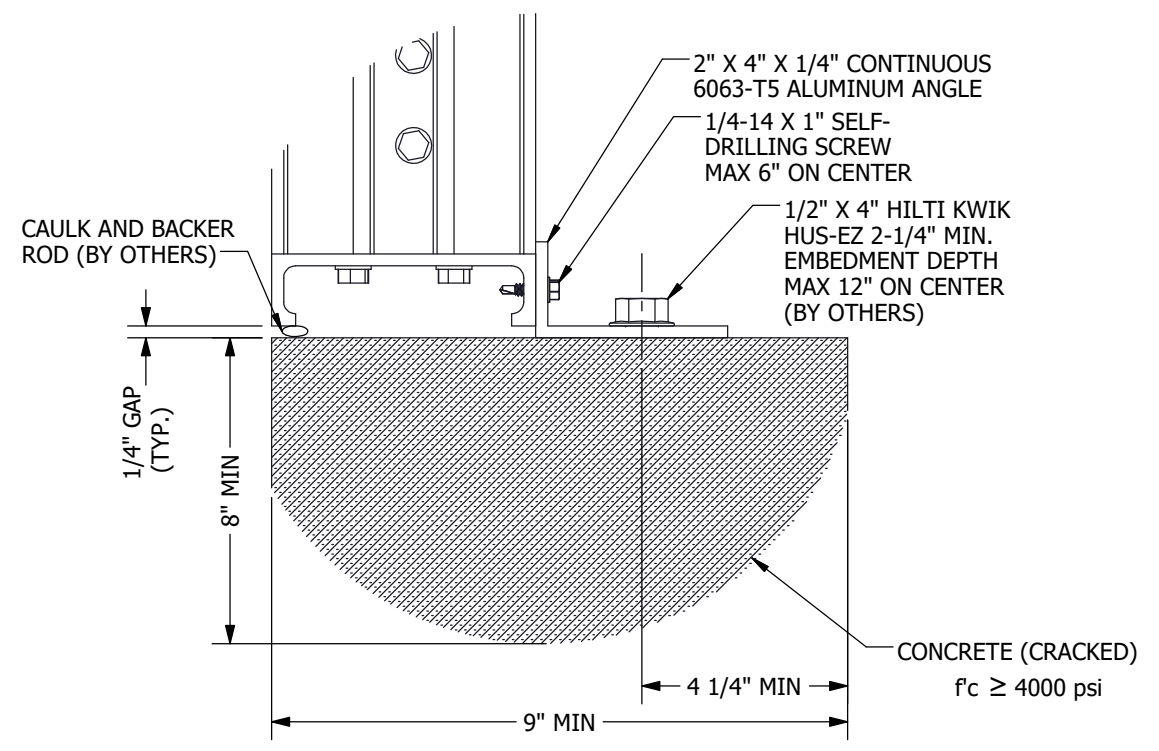

INSTALLATION DETAIL 1 CONCRETE $\geq 8-3/4"$
 SCALE: 3"=1' D-2 D-1

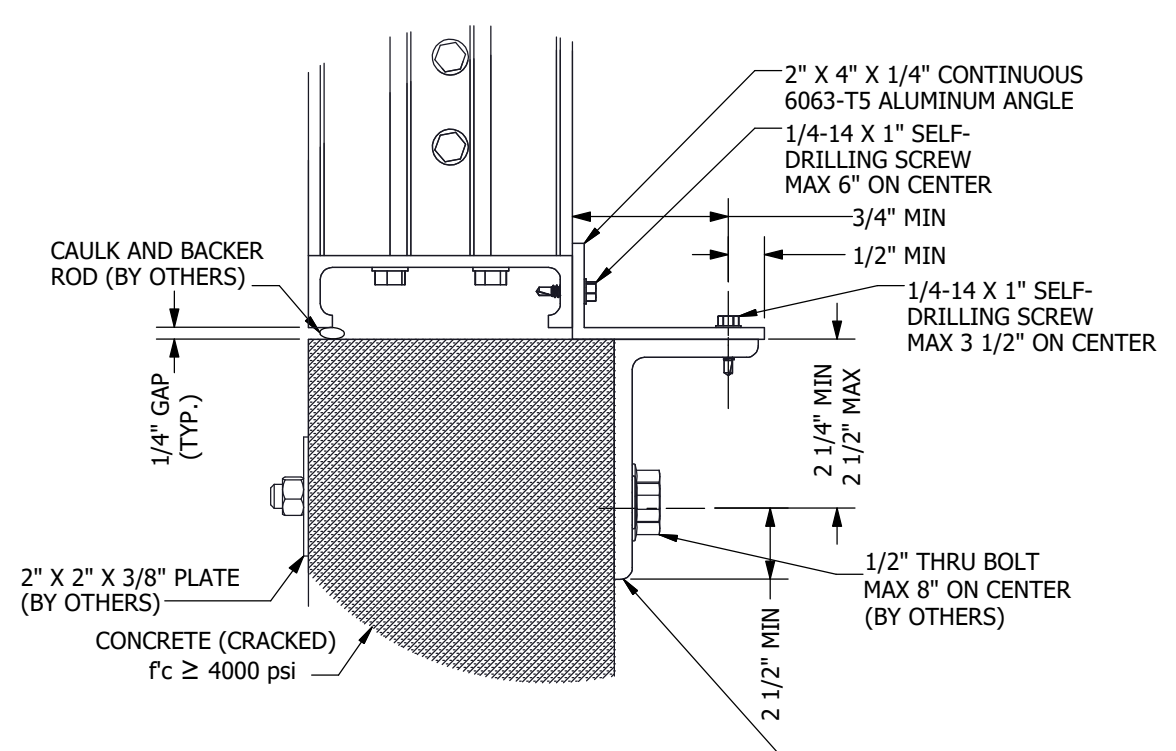

INSTALLATION DETAIL 2 CONCRETE $\leq 8-3/4"$
 SCALE: 3"=1' D-2 D-1

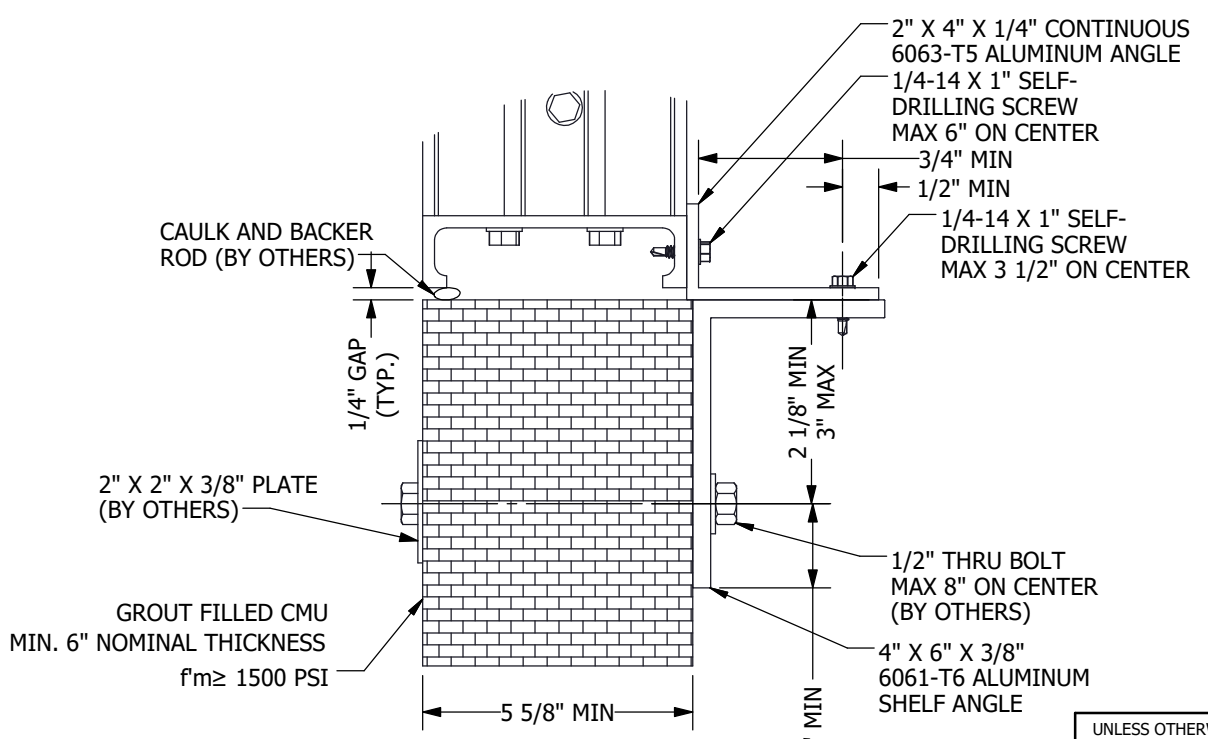

INSTALLATION DETAIL 3 GROUT CMU
 SCALE: 3"=1' D-2 D-1

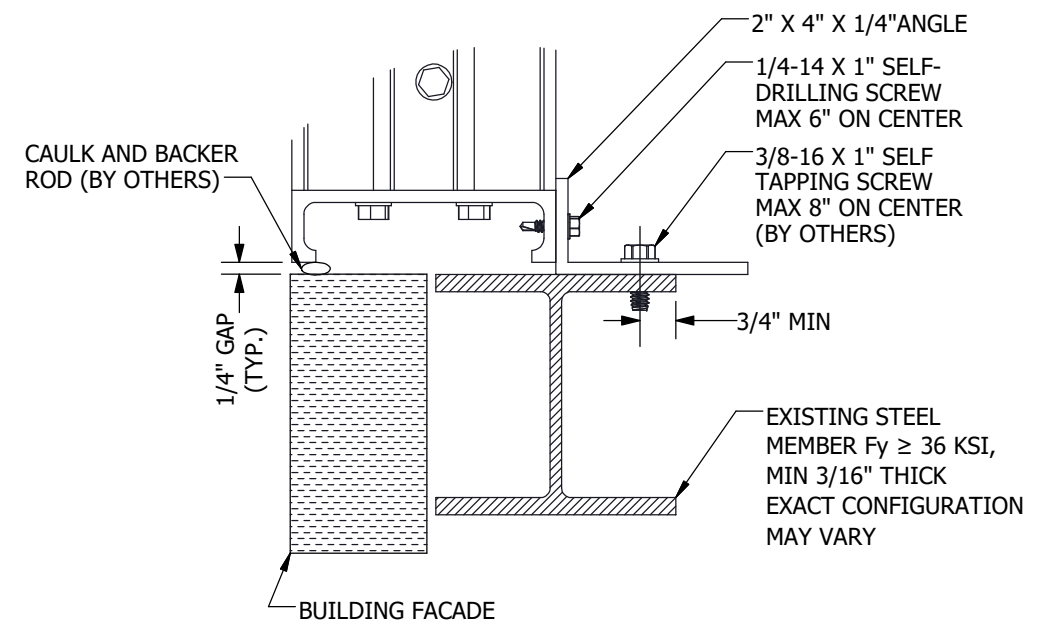

INSTALLATION DETAIL 5 STEEL
 SCALE: 3"=1' D-2 D-1

UNLESS OTHERWISE SPECIFIED DIMENSION ARE IN INCHES
 TOLERANCE UNLESS NOTED:
 X.X ±0.060
 X.XX ±0.030
 X.XXX ±0.010
 ANGLE ±1°
 FRACTION ±1/16
 MAX HOLE BREAKOUT: 15% OF MATERIAL THICKNESS

5101 Blue Mound Road
 Fort Worth, Texas 76106
 Phone: 817-509-2300
 Fax: 817-831-3110

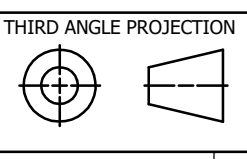

POTTORFF®

THIS DRAWING AND THE DESIGN REPRESENTED ARE THE CONFIDENTIAL AND PROPRIETARY PROPERTY OF PCI INDUSTRIES AND MAY NOT BE DISCLOSED, LOANED, COPIED, OR USED FOR ANY PURPOSE OTHER THAN DESIGN REVIEW AND APPROVAL WITHOUT THE EXPRESS WRITTEN CONSENT OF PCI INDUSTRIES.

DRAWING DESCR: INSTALLATION DETAILS, TOP/BOTTOM				
PROJECT: XCD-545 FEMA 361/320 GRILLE ASSEMBLY & INSTALLATION DETAILS				
LOCATION:				
CUSTOMER:				
PROJ. MGR.: DILLON AUSMUS		DRAWN BY: DJA		
DATE: 5/19/2022	CHK'D BY: JMR	ORDER NUMBER	P.O. NUMBER	DRAWING NUMBER
SHEET: 5 of 9	SCALE: NONE			70219 D-2

NON-FLANGED JAMBS

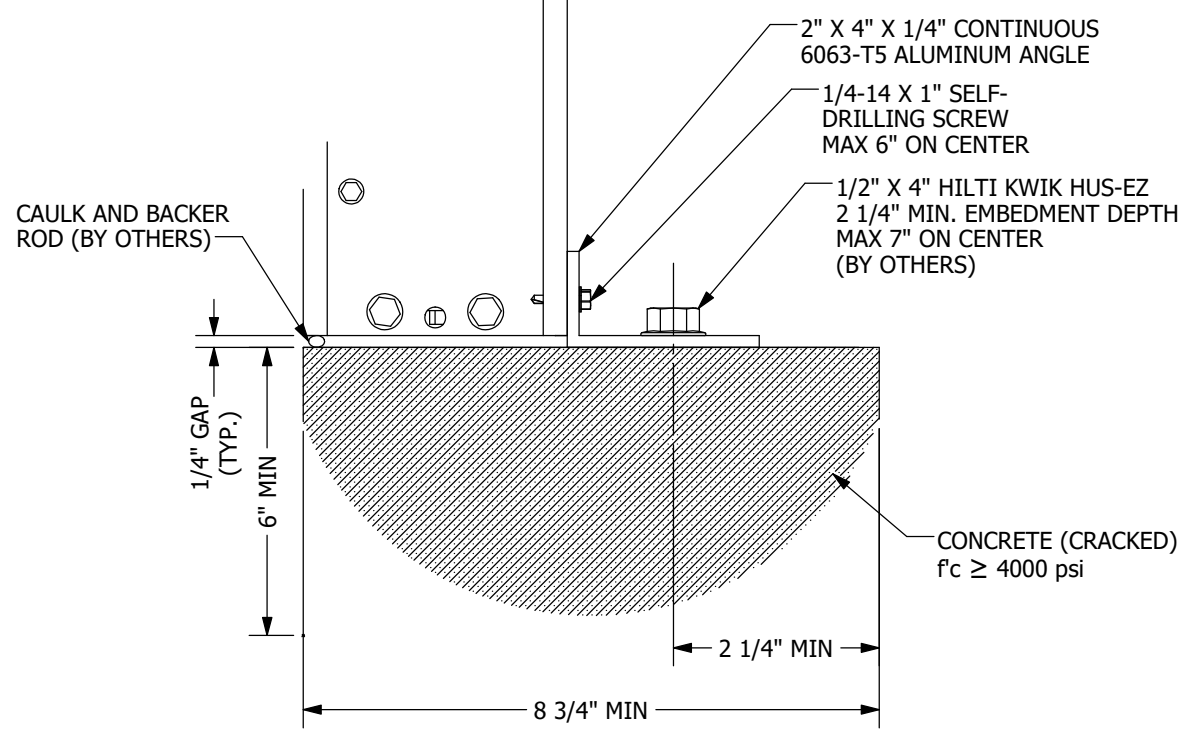

INSTALLATION DETAIL **1** CONCRETE \geq 8-3/4"
SCALE: 3"=1' D-3 JAMB MOUNT

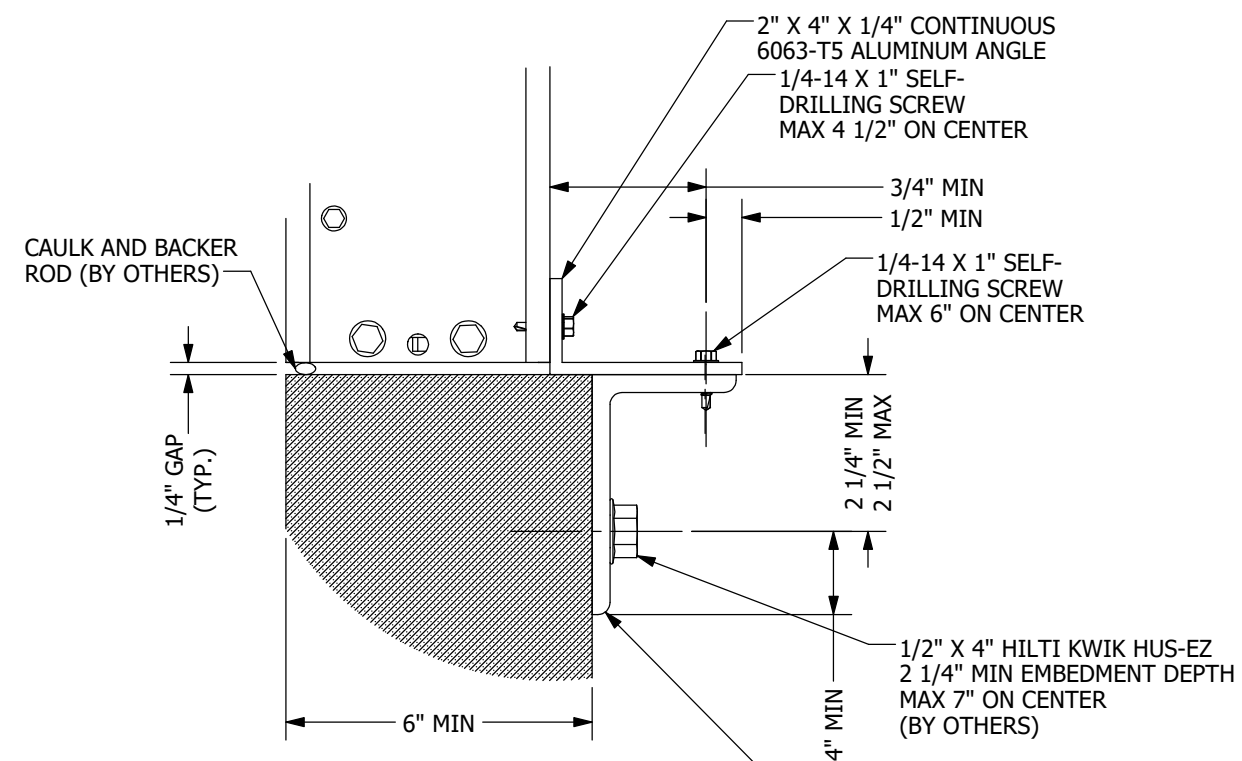

INSTALLATION DETAIL **2** CONCRETE \leq 8-3/4"
SCALE: 3"=1' D-3 JAMB MOUNT

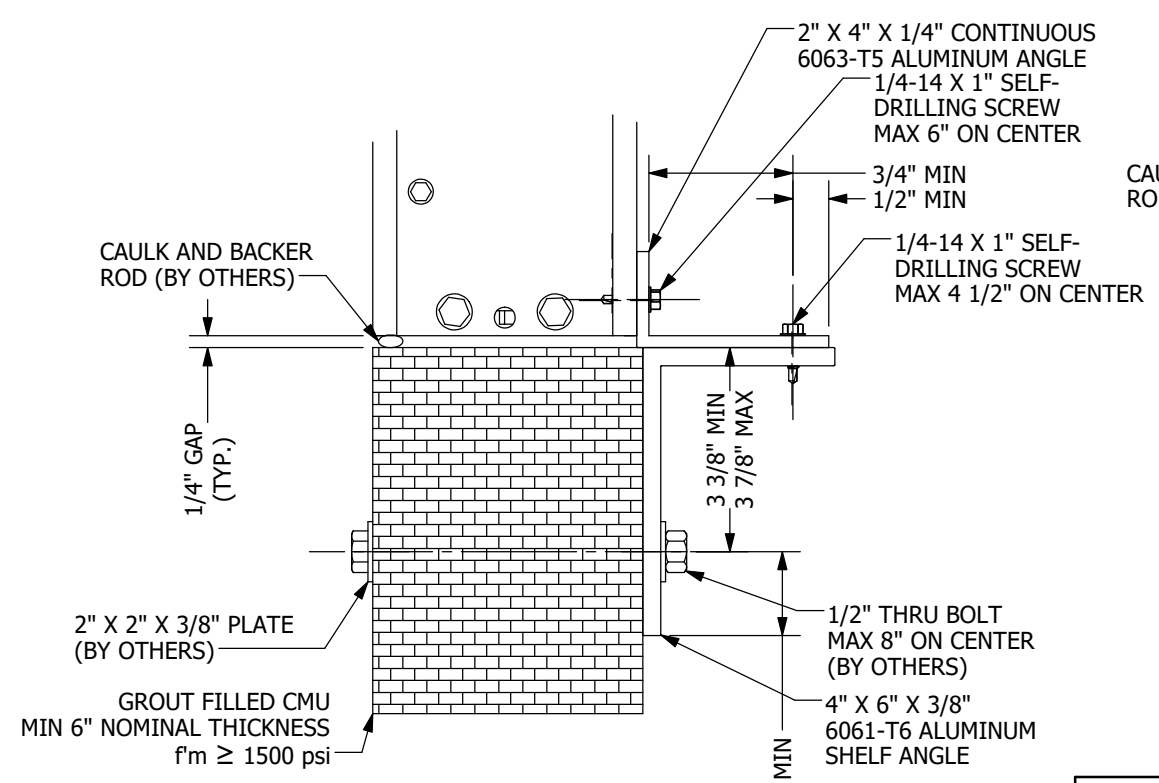

INSTALLATION DETAIL **3** GROUT CMU
SCALE: 3"=1' D-3 JAMB MOUNT

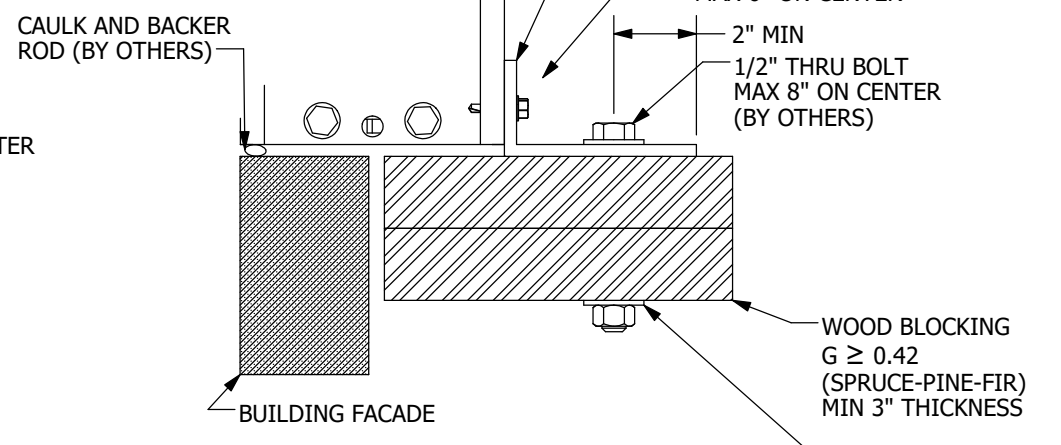

INSTALLATION DETAIL **4** WOOD BLOCKING
SCALE: 3"=1' D-3 JAMB MOUNT

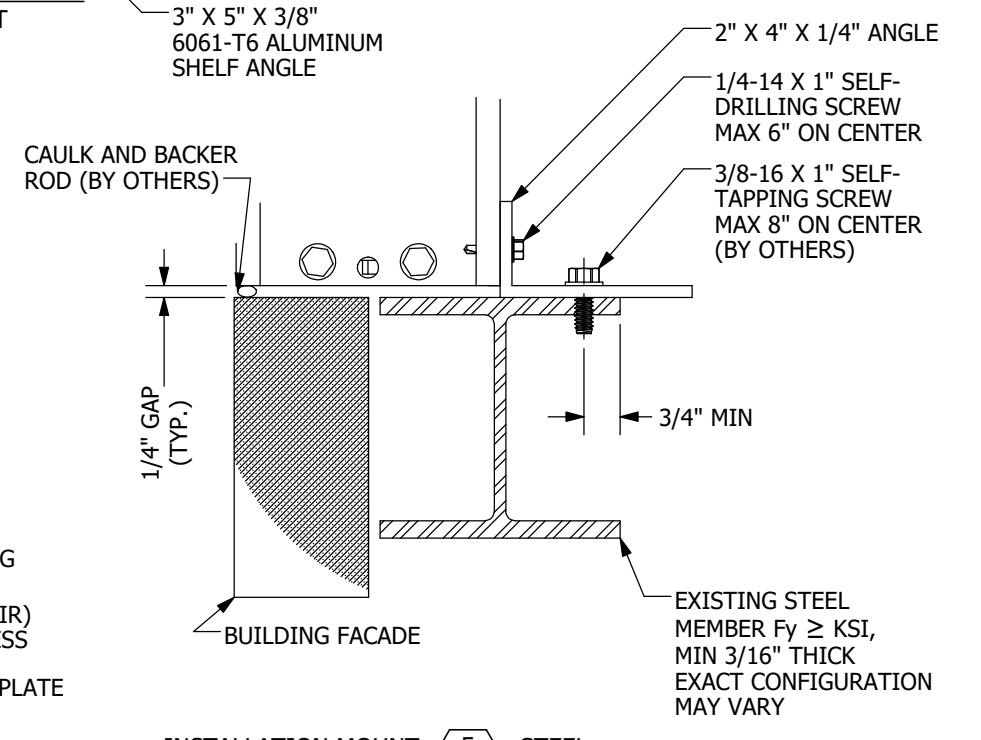

INSTALLATION MOUNT **5** STEEL
SCALE: 3"=1' D-3 JAMB MOUNT

UNLESS OTHERWISE SPECIFIED
DIMENSION ARE IN INCHES

TOLERANCE UNLESS NOTED:
X.X ±0.060
X.XX ±0.030
X.XXX ±0.010
ANGLE ±1°
FRACTION ±1/16

MAX HOLE BREAKOUT:
15% OF MATERIAL THICKNESS

5101 Blue Mound Road
Fort Worth, Texas 76106
Phone: 817-509-2300
Fax: 817-831-3110

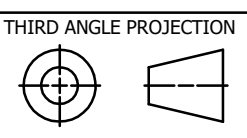

POTTORFF

THIS DRAWING AND THE DESIGN REPRESENTED ARE THE CONFIDENTIAL AND PROPRIETARY PROPERTY OF PCI INDUSTRIES AND MAY NOT BE DISCLOSED, LOANED, COPIED, OR USED FOR ANY PURPOSE OTHER THAN DESIGN REVIEW AND APPROVAL WITHOUT THE EXPRESS WRITTEN CONSENT OF PCI INDUSTRIES.

DRAWING DESCR: INSTALLATION DETAILS, JAMBS				
PROJECT: XCD-545 FEMA 361/320 GRILLE ASSEMBLY & INSTALLATION DETAILS				
LOCATION:				
CUSTOMER:				
PROJ. MGR.: DILLON AUSMUS		DRAWN BY: DJA		
DATE: 5/19/2022	CHK'D BY: JMR	ORDER NUMBER	P.O. NUMBER	DRAWING NUMBER
SHEET: 6 of 9	SCALE: AS NOTED			70219 D-3

MULLION COVER INSTALLATION

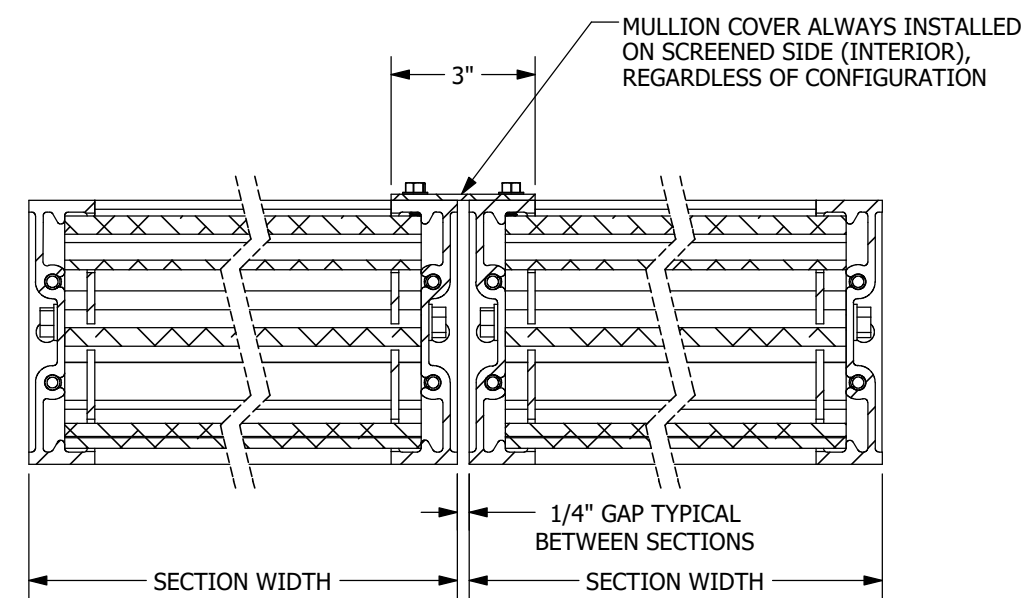
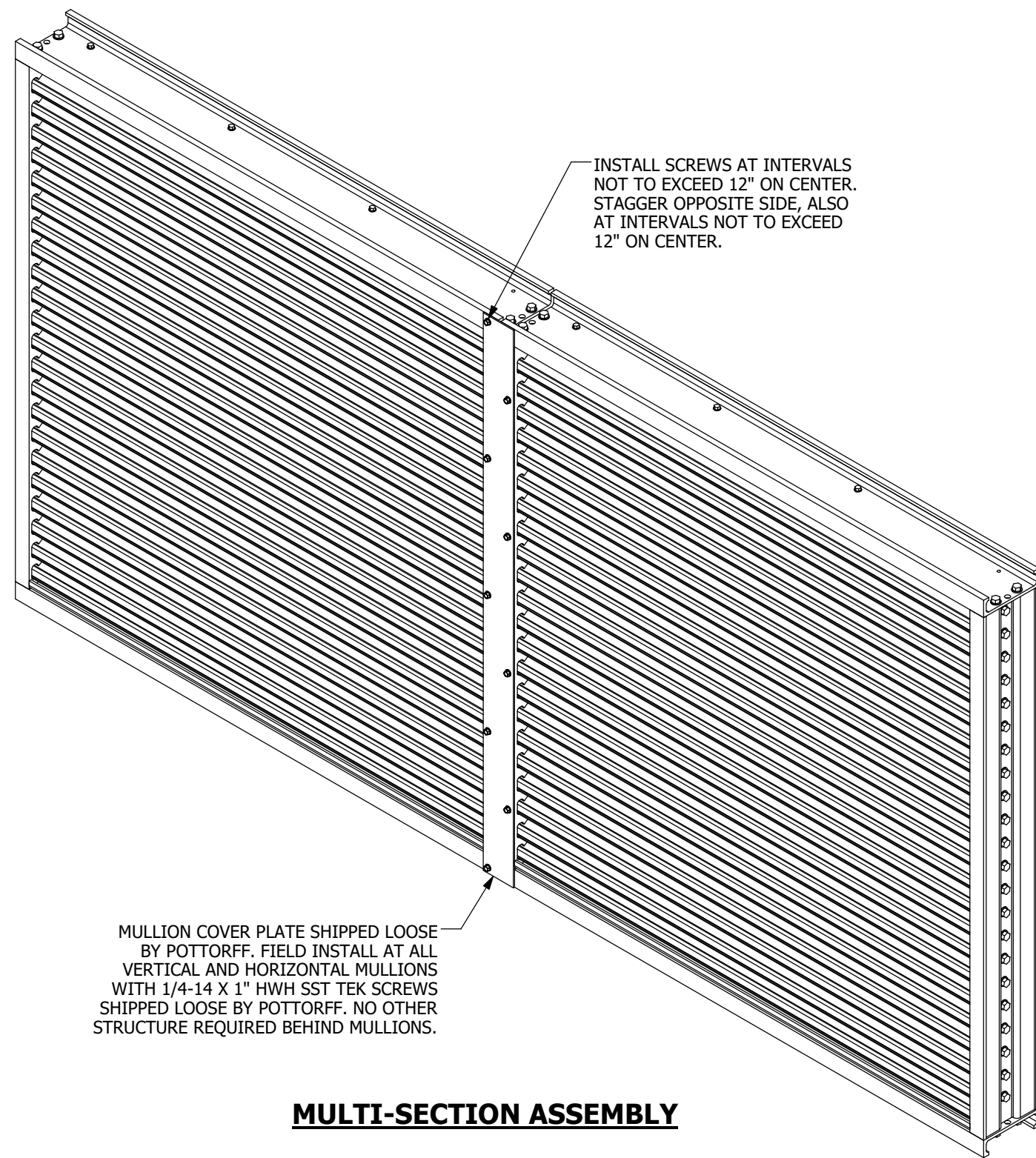

MULLION COVER PLATE SHIPPED LOOSE BY POTTORFF. FIELD INSTALL AT ALL VERTICAL AND HORIZONTAL MULLIONS WITH 1/4-14 X 1" HWH SST TEK SCREWS SHIPPED LOOSE BY POTTORFF. NO OTHER STRUCTURE REQUIRED BEHIND MULLIONS.

MULTI-SECTION ASSEMBLY

UNLESS OTHERWISE SPECIFIED DIMENSION ARE IN INCHES

TOLERANCE UNLESS NOTED:
 X.X ±0.060
 X.XX ±0.030
 X.XXX ±0.010
 ANGLE ±1°
 FRACTION ±1/16

MAX HOLE BREAKOUT:
 15% OF MATERIAL THICKNESS

5101 Blue Mound Road
 Fort Worth, Texas 76106
 Phone: 817-509-2300
 Fax: 817-831-3110

THIRD ANGLE PROJECTION

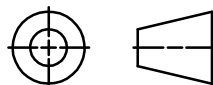

POTTORFF®

THIS DRAWING AND THE DESIGN REPRESENTED ARE THE CONFIDENTIAL AND PROPRIETARY PROPERTY OF PCI INDUSTRIES AND MAY NOT BE DISCLOSED, LOANED, COPIED, OR USED FOR ANY PURPOSE OTHER THAN DESIGN REVIEW AND APPROVAL WITHOUT THE EXPRESS WRITTEN CONSENT OF PCI INDUSTRIES.

DRAWING DESCR: MULLION INSTALLATION				
PROJECT: XCD-545 FEMA 361/320 GRILLE ASSEMBLY & INSTALLATION DETAILS				
LOCATION:				
CUSTOMER:				
PROJ. MGR.: DILLON AUSMUS		DRAWN BY: DJA		
DATE: 5/19/2022	CHK'D BY: JMR	ORDER NUMBER	P.O. NUMBER	DRAWING NUMBER
SHEET: 7 of 9	SCALE: NONE			70219 D-4

ANCHOR REQUIREMENTS

TABLE 3: XCD-545 ANCHOR REQUIREMENTS						
ATTACHMENT METHOD	ATTACHMENT LOCATION	BUILDING SUBSTRATE	ANCHOR TYPE	MIN EDGE DISTANCE	MAX SPACING	MIN EMBEDMENT DEPTH
CONTINUOUS ANGLES (NON-FLANGED, INTERNAL MOUNT ONLY)	JAMBS	GROUT-FILLED CMU ($f'_m \geq 1500$ PSI)	1/2" X 5" HILTI KWIK HUS-EZ SCREW ANCHOR	4"	8"	4 1/4"
		CONCRETE ($f'_c \geq 4000$ PSI)	3/8" X 4" HILTI KWIK HUS-EZ SCREW ANCHOR	2 1/4"	12"	3 1/4"
		STEEL (MIN 3/16" THICK, $F_y \geq 36$ KSI)	3/8" X 1" SELF TAPPING SCREW*	3/4"	12"	3/16"
	TOP & BOTTOM	GROUT-FILLED CMU ($f'_m \geq 1500$ PSI)	1/2" THROUGH-BOLT W/ NUT & FLAT WASHER	3 3/8"	8"	FULL
		CONCRETE ($f'_c \geq 4000$ PSI)	5/8" X 4" HILTI KWIK HUS-EZ SCREW ANCHOR	2 1/4"	7"	3 1/4"
		STEEL (MIN 3/16" THICK, $F_y \geq 36$ KSI)	3/8" X 1" SELF TAPPING SCREW*	3/4"	8"	3/16"
		WOOD BLOCKING	1/2" THROUGH-BOLT W/ NUT & FLAT WASHER	2"	6"	FULL

*NOTE: IT IS ACCEPTABLE TO SUBSTITUTE 3/8-16 BOLTS, NUTS, AND FLAT WASHERS INSTEAD OF 3/8" SELF-TAPPING SCREWS.

<p>UNLESS OTHERWISE SPECIFIED DIMENSION ARE IN INCHES</p> <p>TOLERANCE UNLESS NOTED:</p> <p>X.X ±0.060 X.XX ±0.030 X.XXX ±0.010 ANGLE ±1° FRACTION ±1/16</p> <p>MAX HOLE BREAKOUT: 15% OF MATERIAL THICKNESS</p>	<p>5101 Blue Mound Road Fort Worth, Texas 76106 Phone: 817-509-2300 Fax: 817-831-3110</p>		<p>DRAWING DESCR: ANCHOR REQUIREMENTS</p> <p>PROJECT: XCD-545 FEMA 361/320 GRILLE ASSEMBLY & INSTALLATION DETAILS</p> <p>LOCATION:</p> <p>CUSTOMER:</p> <table style="width: 100%; border: none;"> <tr> <td style="border: none;">PROJ. MGR.: DILLON AUSMUS</td> <td style="border: none;">DRAWN BY: DJA</td> </tr> </table> <table style="width: 100%; border: none;"> <tr> <td style="border: none;">DATE: 5/19/2022</td> <td style="border: none;">CHK'D BY: JMR</td> <td style="border: none;">ORDER NUMBER</td> <td style="border: none;">P.O. NUMBER</td> <td style="border: none;">DRAWING NUMBER</td> </tr> <tr> <td style="border: none;">SHEET: 8 of 9</td> <td style="border: none;">SCALE: NONE</td> <td></td> <td></td> <td style="border: none; text-align: center;">70219 D-5</td> </tr> </table>	PROJ. MGR.: DILLON AUSMUS	DRAWN BY: DJA	DATE: 5/19/2022	CHK'D BY: JMR	ORDER NUMBER	P.O. NUMBER	DRAWING NUMBER	SHEET: 8 of 9	SCALE: NONE			70219 D-5
PROJ. MGR.: DILLON AUSMUS	DRAWN BY: DJA														
DATE: 5/19/2022	CHK'D BY: JMR	ORDER NUMBER	P.O. NUMBER	DRAWING NUMBER											
SHEET: 8 of 9	SCALE: NONE			70219 D-5											

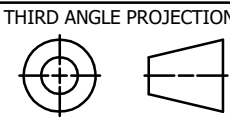

THIS DRAWING AND THE DESIGN REPRESENTED ARE THE CONFIDENTIAL AND PROPRIETARY PROPERTY OF PCI INDUSTRIES AND MAY NOT BE DISCLOSED, LOANED, COPIED, OR USED FOR ANY PURPOSE OTHER THAN DESIGN REVIEW AND APPROVAL WITHOUT THE EXPRESS WRITTEN CONSENT OF PCI INDUSTRIES.

EXTRUDED PART DETAILS

DESCRIPTION: CHEVRON STLYE BLADE
 MATERIAL: 6061-T6 ALUMINUM
 POTTORFF PART NO: 61236
 SCALE: 6" = 1'-0"

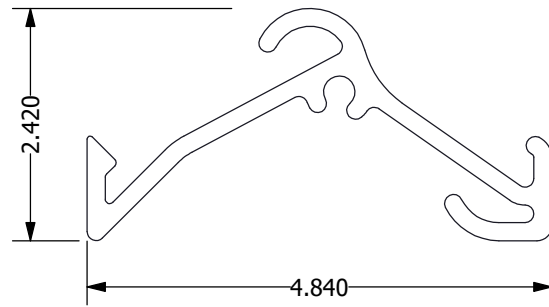

DESCRIPTION: 2" X 4" X 1/4" ANGLE
 MATERIAL: 6063-T5 ALUMINUM
 POTTORFF PART NO: 12937
 SCALE: 6" = 1'-0"

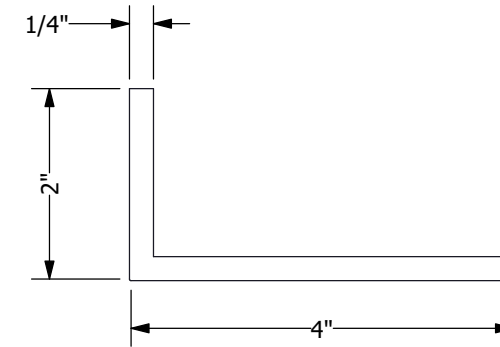

DESCRIPTION: JAMB FRAME EXTRUSION
 MATERIAL: 6005A-T6 ALUMINUM
 POTTORFF PART NO: 61237
 SCALE: 6" = 1'-0"

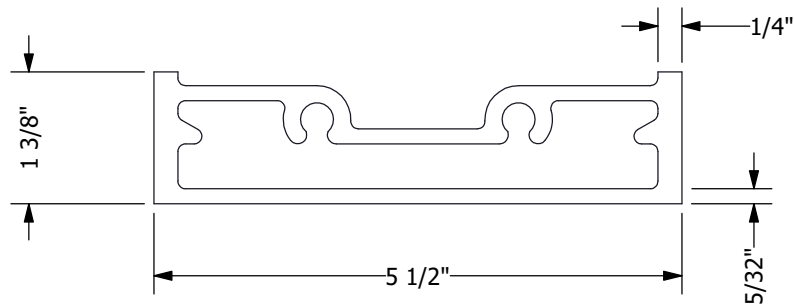

DESCRIPTION: 3" X 1/8" BAR
 MATERIAL: 6063-T52 ALUMINUM
 POTTORFF PART NO: 50617
 SCALE: 1' = 1'-0"

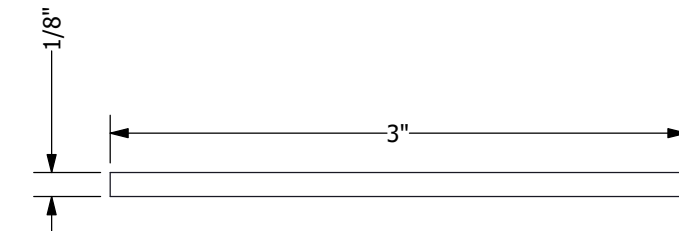

DESCRIPTION: HEAD/SILL FRAME EXTRUSION
 MATERIAL: 6005A-T61 ALUMINUM
 POTTORFF PART NO: 59976
 SCALE: 6" = 1'-0"

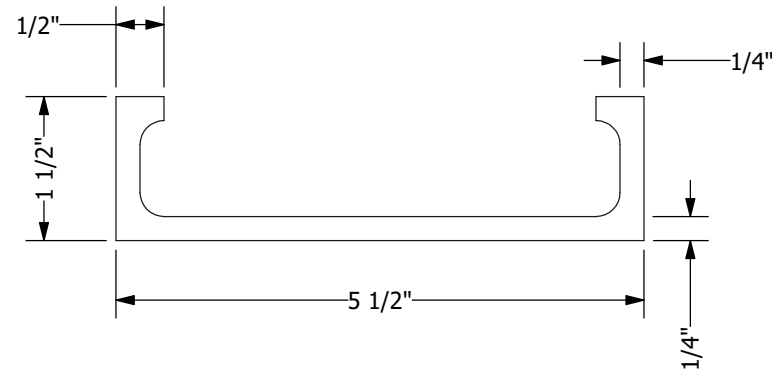

UNLESS OTHERWISE SPECIFIED
 DIMENSION ARE IN INCHES

TOLERANCE UNLESS NOTED:
 X.X ±0.060
 X.XX ±0.030
 X.XXX ±0.010
 ANGLE ±1°
 FRACTION ±1/16

MAX HOLE BREAKOUT:
 15% OF MATERIAL THICKNESS

5101 Blue Mound Road
 Fort Worth, Texas 76106
 Phone: 817-509-2300
 Fax: 817-831-3110

THIRD ANGLE PROJECTION

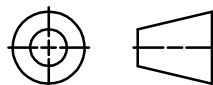

POTTORFF

THIS DRAWING AND THE DESIGN REPRESENTED ARE
 THE CONFIDENTIAL AND PROPRIETARY PROPERTY OF
 PCI INDUSTRIES AND MAY NOT BE DISCLOSED, LOANED,
 COPIED, OR USED FOR ANY PURPOSE OTHER THAN DESIGN
 REVIEW AND APPROVAL WITHOUT THE EXPRESS WRITTEN
 CONSENT OF PCI INDUSTRIES.

DRAWING DESCR: EXTRUSION PART DETAILS				
PROJECT: XCD-545 FEMA 361/320 GRILLE ASSEMBLY & INSTALLATION DETAILS				
LOCATION:				
CUSTOMER:				
PROJ. MGR.: DILLON AUSMUS		DRAWN BY: DJA		
DATE: 5/19/2022	CHK'D BY: JMR	ORDER NUMBER	P.O. NUMBER	DRAWING NUMBER
SHEET: 9 of 9	SCALE: AS NOTED			70219 D-6